

SPECS FOR FENCING PROJECT

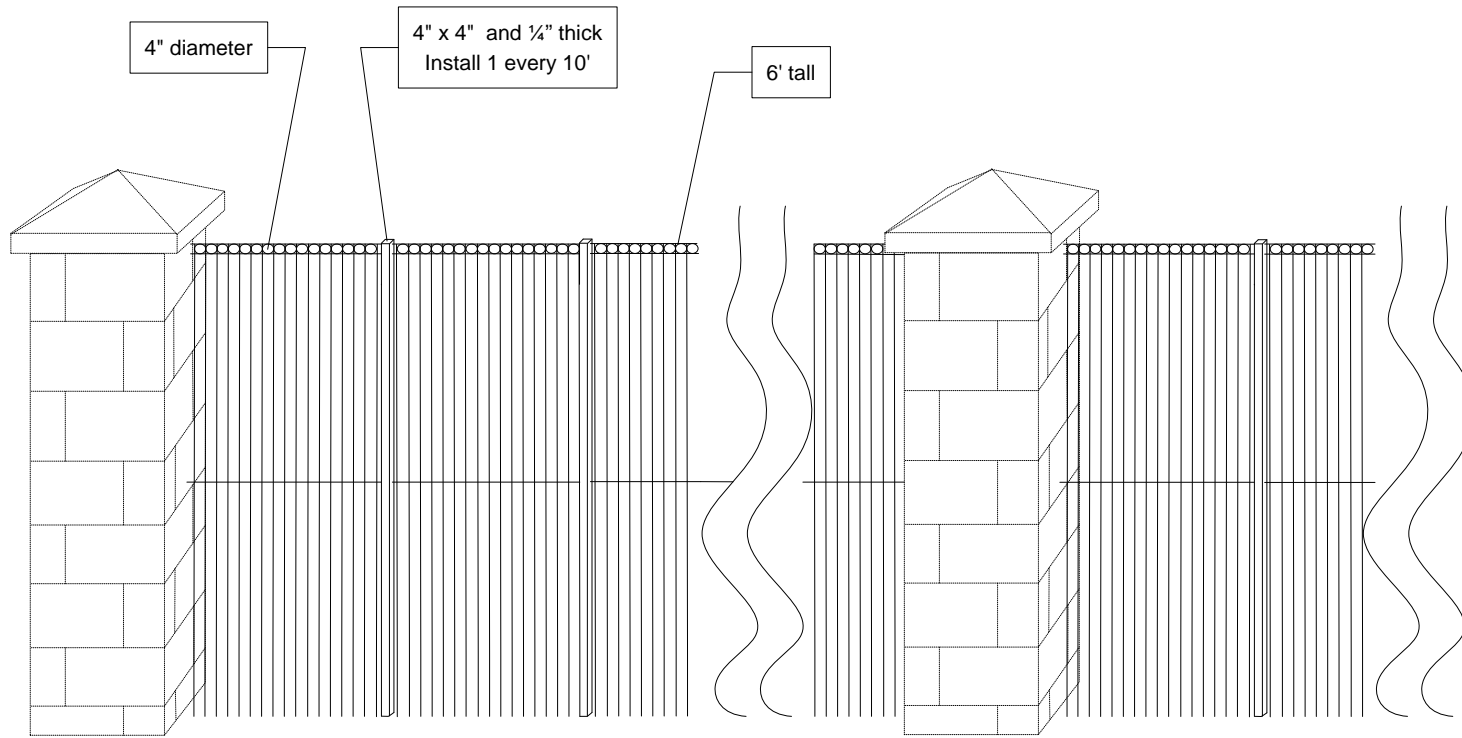

NOTES:

1. Gates to be anchored to a 4"x4"x 1/2" thick metal beam and buried 4' into the ground with cement and rebar frame. Hole must be 2' x 2' to hold the weight of each gate.
2. 1185 and 1/2 linear feet of rod-iron fence as seen in drawing above.
3. 25 block/cement columns
4. 4 - 16' gates, 2 - 12' gates and 2- 10' gates

- Specify as to time required to complete project
- Deadline to submit bid will be July 30, 2008 before 5:00p.m. at the Business Office
- Call Norberto Mendiola, Finance Director, for any questions @ (956) 843-8825

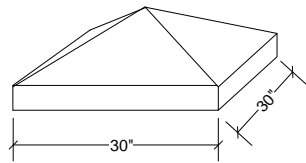
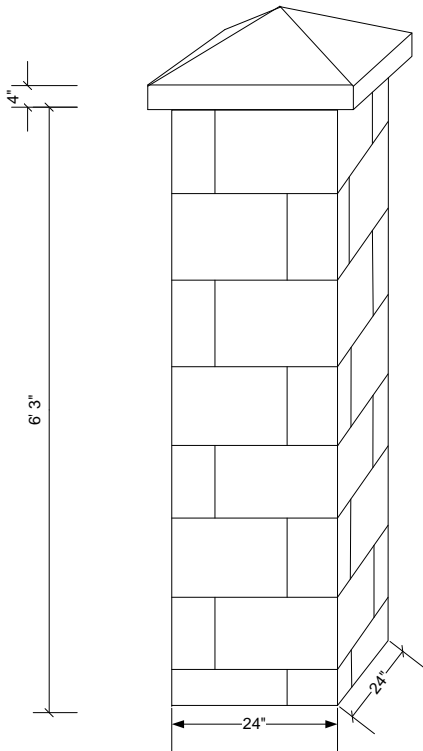

- NOTES:
1. Install 1/2" rebar at 5' 9" crossing from side to side east-west direction in the middle of the block column
 2. Install 1/2" rebar at 5' 4.5" crossing from side to side east-west direction in the middle of the block column
 3. Install 1/2" rebar at 2' 9" crossing from side to side east-west direction in the middle of the block column

Under ground cement footing
Top of footing 3" above ground

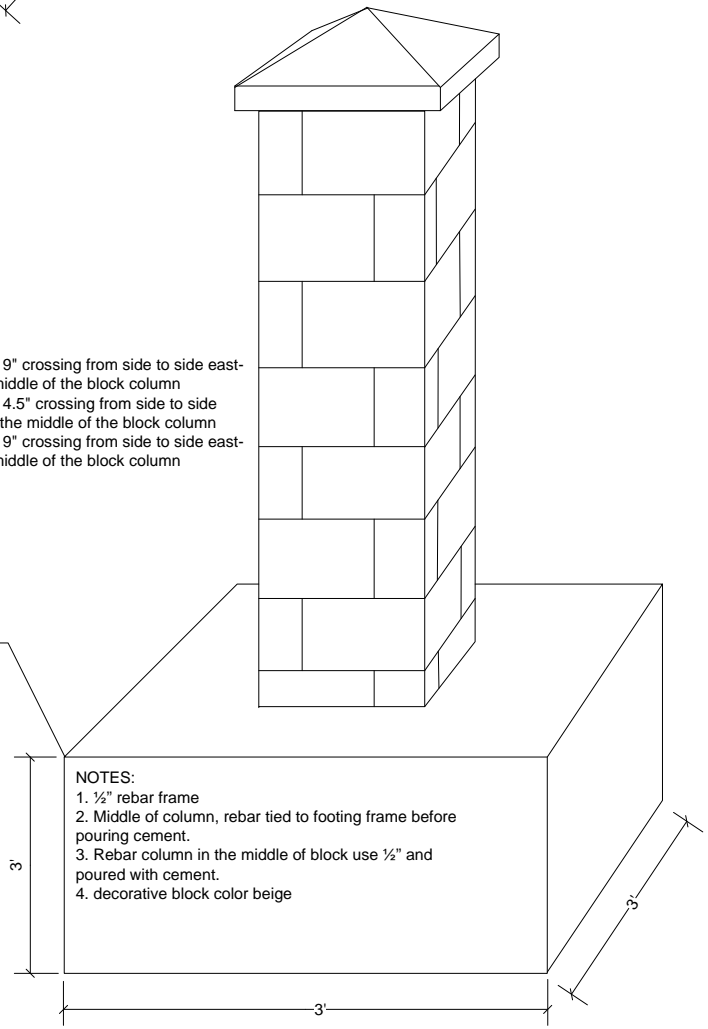

- NOTES:
1. 1/2" rebar frame
 2. Middle of column, rebar tied to footing frame before pouring cement.
 3. Rebar column in the middle of block use 1/2" and poured with cement.
 4. decorative block color beige